

Assembly Sheet for CL-Kit 3

CONTENTS:

1 x PL46
(Plastic Wall Strip)



8 x CL-MC
(Mounting Clips)



16 x CL-108
(DL Brochure Holders)



4 x CL-SB
(Supporting Bracket)



24 x CL-SJC
(Side Joining Clips)



STEP 1

Secure wall strip onto wall.
Refer to your builder/handyman for
formats of securing to wall
For Example:-
For mounting onto Gyprock walls,
suggest using 'Wall Mates'.
For concrete/brick walls suggest
using wall plugs etc



STEP 2

Attach the two
Mounting Clips into
top keyholes of the
first pocket

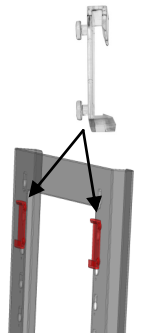

STEP 3

Attach holder
onto the wall strip

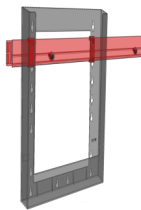

STEP 4

For subsequent
pockets attach Side
Joining Clips into the
keyholes (at desired
overlap spacing) to both
sides of the holder

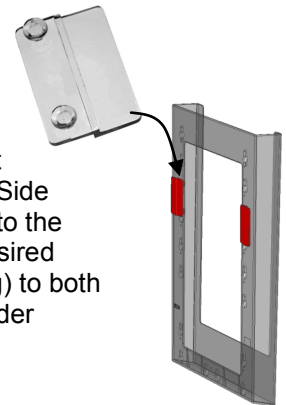

STEP 5

Slide the back of the
pocket onto the front of
the pocket already mounted to
Wall Strip

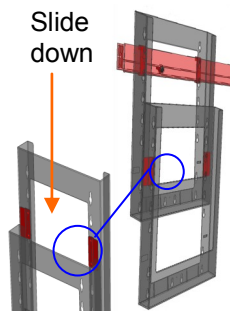

Down Joining Clips grip the
face of the preceding pocket.

Go down 4 levels of pockets

STEP 7

Repeat
another 3 rows

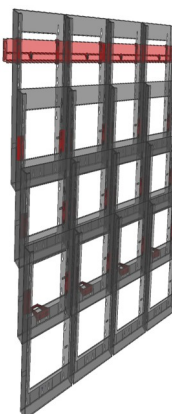

STEP 6

Fit Supporting
Bracket onto the
back of
third pocket

