



Retail Visual
Merchandising
Systems



SLATWALL
Panels & Floor Fixtures

SLATWALL

SLATWALL

Panels & Floor Fixtures



Marlite Slatwall panels and floor fixtures: reliable and affordable merchandising choice.

Marlite manufactures Slatwall at several of our manufacturing locations. Displawall Slatwall offers the retail industry's most complete selection of slotted wall panels as well as floor fixtures. This reliable and affordable visual merchandising Slatwall display system can be specified for your entire store.

Ideal for all types of apparel, sport items, shoes and other horizontal displays. Find out more about Marlite Slatwall, Slatwall accessories, panel pricing, lead times and custom options for your retail environment!

Marlite Slatwall can be customized with optional groove treatments.

Metal inserts, vinyl trim strips, vinyl color snaps or painted grooves. From light duty to medium duty applications, Marlite has the product you need. Available in your choice of Painted High Pressure Laminate Finishes, Marlite Finish, Wood Veneer, Low Pressure Melamine and custom finishes. The look you want, the durability you need. In Slatwall panels and floor fixtures – all from Marlite!





Slatwall is available in a variety of finishes.

Finish Options

Painted Finishes

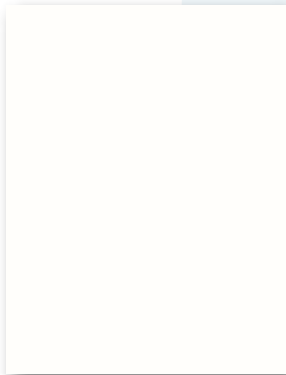

703 Brite White

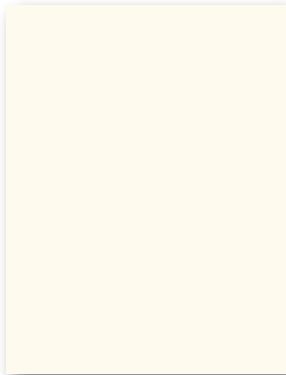

415 Frost White

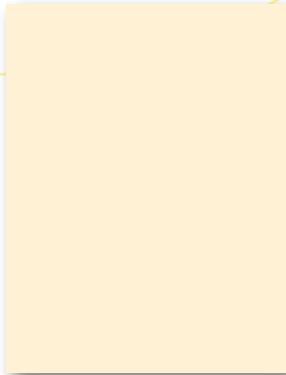

515 Almond

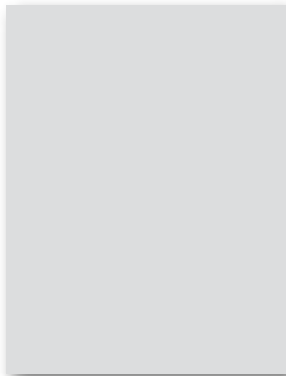

764 Crystal Gray

Marlite Finishes



310 Sierra Maple



317 Alum Rock Maple



318 Windsor Anigre



319 Whittier Anigre



342 Champagne Maple

Specialty Finishes



020 Red Oak Veneer



041 White Birch Veneer



601 Clear Mirrored Acrylic

Custom Capabilities

Select from our full Marlite Finish Palette at www.marlite.com or create your own finish. Simply submit a laminate chip or swatch of the print pattern/color desired, and we'll send a lab sample match within a few days. (Minimum order requirements and other terms apply.)

The Marlite Finish is a richly detailed and easy to maintain surface that is more economical than decorative laminates. The base coat, precision coats, print coats and melamine top coat are all applied to the highest quality MDF substrate. Each panel is baked for a durable finish.

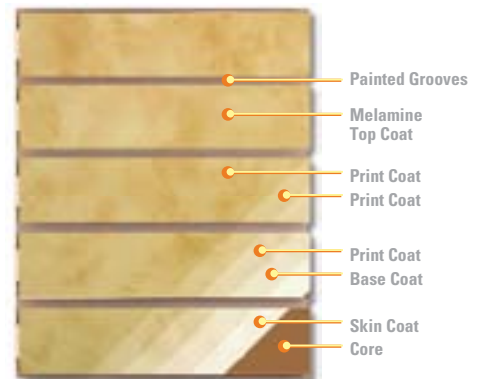

Low Pressure Melamine

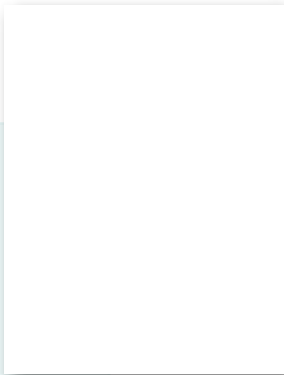

750 Goshen White LPM

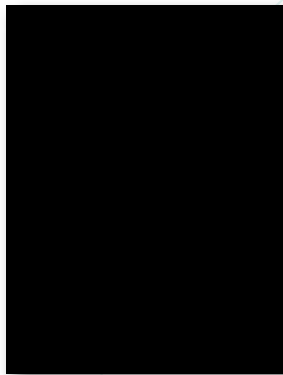

844 Trojan Black LMP



687 Hard Maple LPM



738 Brushed Aluminum LPM

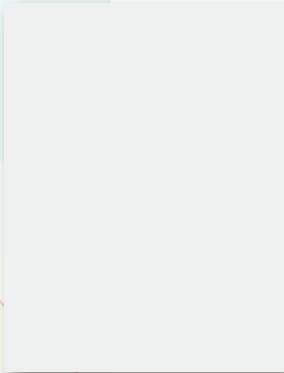

751 Stone Gray LPM



975 Cherry LPM

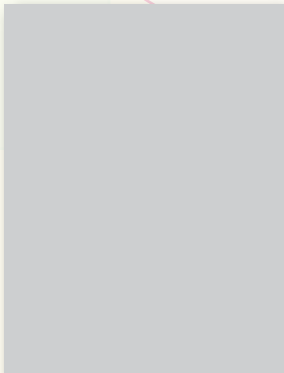

742 Tornado Gray LMP



692 Fine Oak LPM

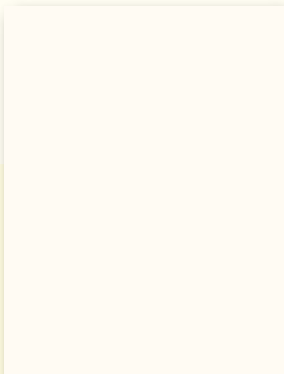

744 Swiss Almond LPM



711 Linn Birch LPM

High Pressure Laminate



Custom High Pressure Laminate can be ordered to your specifications from any domestic or foreign laminate manufacturer.

Hooks, Brackets & Arms

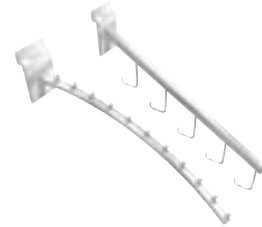
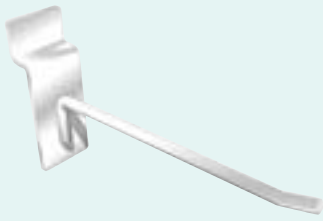

Straight Hooks

100 pcs/carton

Hook 1" 149824	Hook 8" 149830
Hook 4" 149827	Hook 10" 149825
Hook 6" 149829	Hook 12" 149826

Shelf Brackets

50 pcs/carton

Knife 149823 – Bracket 8"
Knife 149818 – Bracket 10"
Knife 149820 – Bracket 12"
Knife 149821 – Bracket 14"

Arms

25 pcs/carton

Rectangular 149819 – Faceout 12"
Rectangular 149828 – Waterfall 5, Hook 14"
Rectangular 149822 – Waterfall 6, Ball 16"

Trim

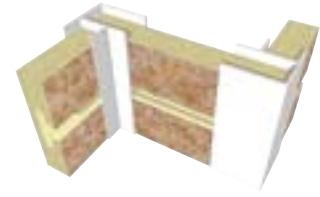
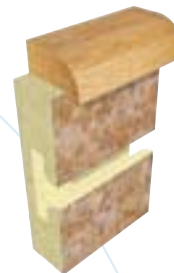
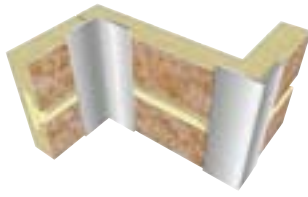
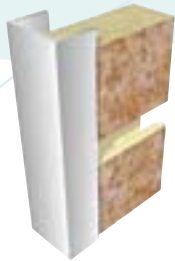

A770 Edge (aluminum)
 $\frac{1}{2}$ " x $1\frac{3}{16}$ " x 96"
 121259
 Mill Finish

A760 Inside/Outside Corner (aluminum)
 1" x 1" x 96"
 121095
 Mill Finish

M770 Edge
 $\frac{5}{16}$ " x $\frac{3}{4}$ " x 120"
 122666
 Satin

W770 Edge (poplar)
 $\frac{9}{16}$ " x 1" x 96"
 121294
 To be field finished.

P760 Inside/Outside Corner (pvc)
 $1\frac{3}{8}$ " x $1\frac{3}{8}$ " x 96"
 121085 D100 White
 $1\frac{3}{8}$ " x $1\frac{3}{8}$ " x 96"
 121087 D109 Gray

Installation Rail Assembly

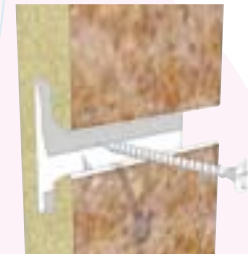
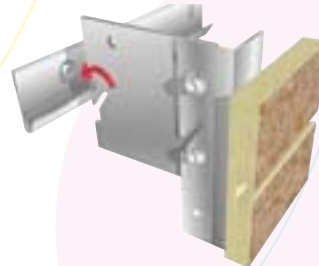
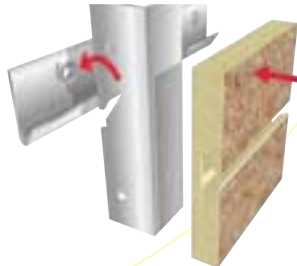

P770 Edge (pvc)
 $\frac{7}{8}$ " x $\frac{1}{2}$ " x 96" 121084
 D100 White
 $\frac{7}{8}$ " x $\frac{1}{2}$ " x 96" 121086
 D109 Gray

Mounting Track
 $\frac{5}{8}$ " x $1\frac{1}{8}$ " x 96" 122685
 Steel, Silver, Powder Coat
Panel Bar
 $1\frac{1}{2}$ " x $1\frac{1}{2}$ " x 84" 122686
 Silver Power Coat

- Combination of Mounting Track and Panel Bar create Marlite Rail Assembly.
- Mounting Track and Panel Bar are predrilled for easy installation.
- 4" extension brackets available

Color Match Screws
 1000 pcs/box
 Phillips, bugle head, coarse thread screws. One box installs approximately 23 panels (4' x 8').
 6" x $1\frac{5}{8}$ " 102182
 415 Frost White

Groove Treatments

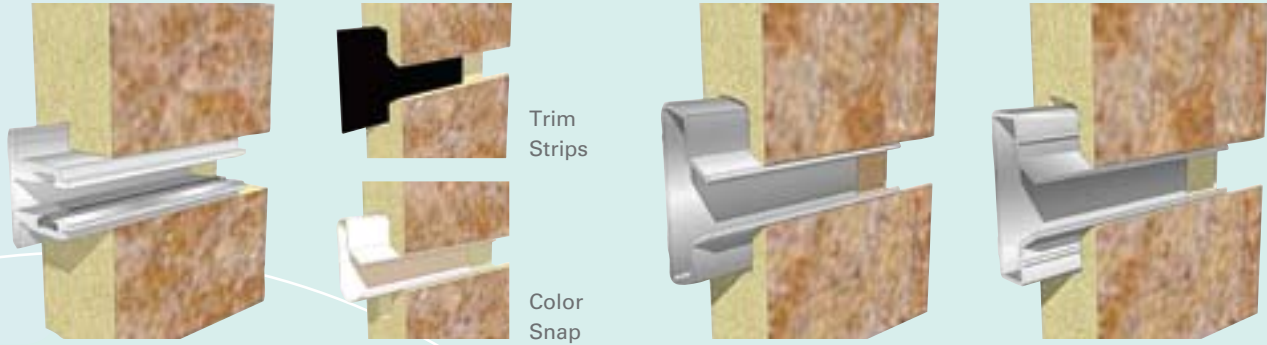

1000 Series Slatwall
For light duty application feature merchandising. A unique aluminum insert accepts 1/4" glass or acrylic shelving. Secure shelving without the use of brackets.

2000 Series Slatwall
For light duty application with accessory brackets. Vinyl trim strips – white, black. Vinyl color snaps – white, red, platinum, black, ivory
Field install

5000 Series Slatwall
For light duty application with accessory brackets. Vinyl inserts – white, black.
Factory installed only

7000 Series Slatwall
For medium duty application with accessory brackets. Aluminum insert – mill, black.
Factory installed only

Renu™ your Slatwall



Renu decorative thermoplastics are precisely cut to fit Marlite Slatwall, supplied in 4 foot long strips with a pressure sensitive adhesive backing for easy installation. Apply on existing slatwall without closing store or removing panels. Cover entire walls or just sections to enhance the look & décor of your retail environment.

Features:

- Embossed designs & colors for 2000, 5000 or 7000 series
- Super Fast Installation
- High Impact & Scratch Resistant
- Made with pride in the USA

It's as simple as ...

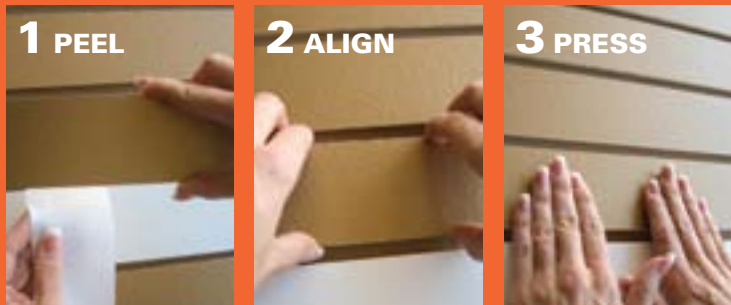

Stock Designs



Triple Tread Plate

Curves

Wave

Circles

Stock Colors



Argent Silver

Argent Gold

Argent Copper

Argent Bronze

Slatwall

Dimensions™ slotted panels

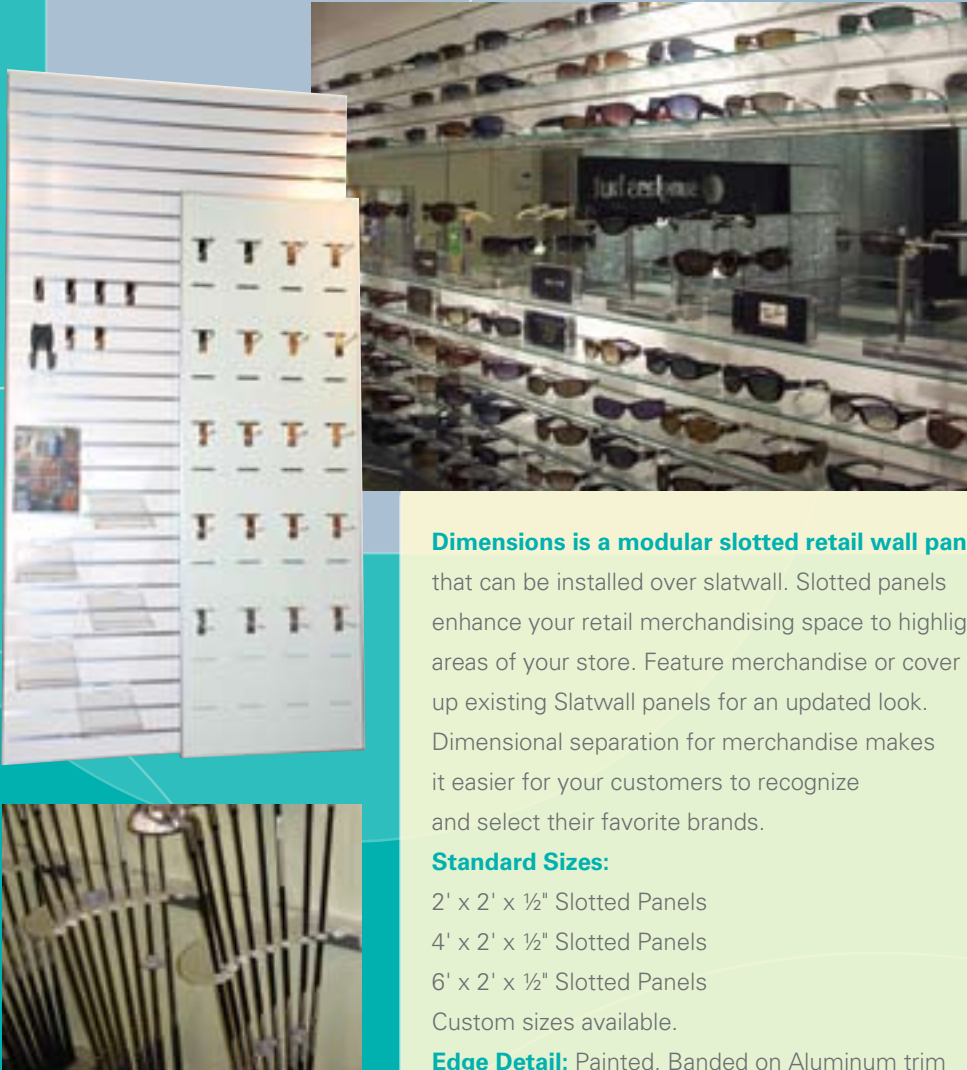

Dimensions is a modular slotted retail wall panel

that can be installed over slatwall. Slotted panels enhance your retail merchandising space to highlight areas of your store. Feature merchandise or cover up existing Slatwall panels for an updated look. Dimensional separation for merchandise makes it easier for your customers to recognize and select their favorite brands.

Standard Sizes:

2' x 2' x ½" Slotted Panels

4' x 2' x ½" Slotted Panels

6' x 2' x ½" Slotted Panels

Custom sizes available.

Edge Detail: Painted, Banded on Aluminum trim



Dover, Ohio 44622 • 800-377-1221 • www.marlite.com • info@marlite.com

Form No. DW52-08091

Effective Date 08/01/09

Printed in U.S.A.

Marlite is committed to protecting our environment and sustaining resources for future generations.



Printed on Recycled Paper